

This document and its design content is copyright ©. It shall be read in conjunction with all other associated project information including models, specifications, schedules and related consultants documents. Do not scale from documents. All dimensions to be checked on site. Immediately report any discrepancies, errors or omissions on this document to the Originator. If in doubt ASK.

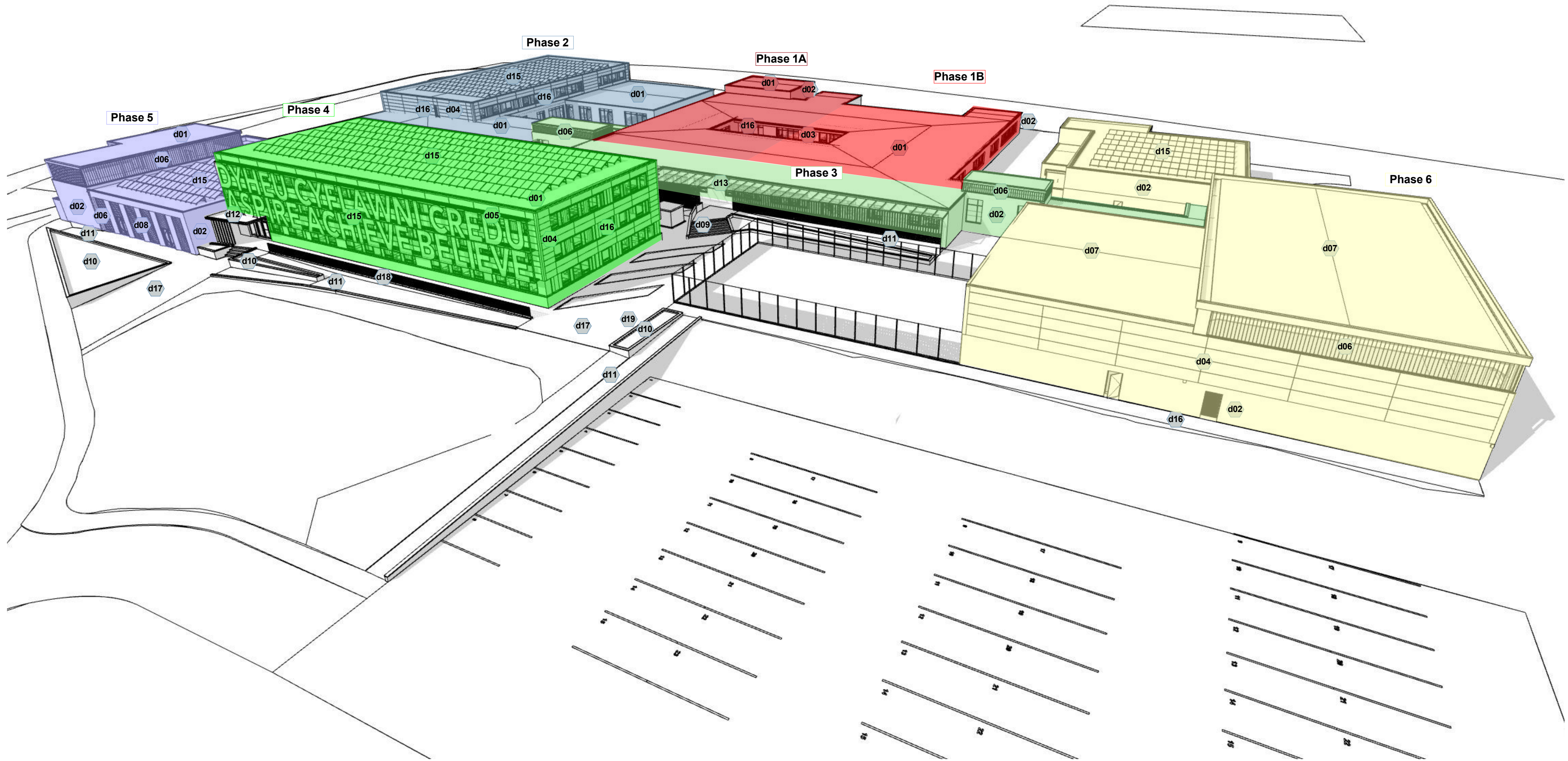

**LEGEND**

- d01** Provide new reinforced bitumen roof with insulation as Alumasc report and NBS J41/110
- d02** New rendered external wall insulation with Keim paint finish as NBS M21/230 & M60/170
- d03** New rendered external wall insulation with murals in Keim paint finish as NBS M21/230 & M60/170 Content TBA by negotiation with school
- d04** New composite PPC flat aluminium cladding panels with recessed joints fixed to existing walls as NBS H43/120
- d05** New louvre panel cladding with live louvres as required as NBS L10/650
- d06** New double layer translucent channel glass as NBS H13/115
- d07** Existing flat to pitched roof removed, and new insulation and roof covering provided over original as NBS J41/110
- d08** Champagne coloured textured steel cladding panels as NBS H31/120
- d09** Existing steps removed and replaced with new, with concrete paviors as NBS Q25/315A
- d10** New raised planters constructed from charcoal engineering brick as NBS F10/110
- d11** New 1:30 concrete ramps constructed with charcoal brick retaining walls and PCC copings as NBS F10/110 - F30/760.
- d12** Existing canopy removed and replaced with new canopy with PPC aluminium fascias as NBS supported on steel posts with textured cladding as NBS H72/250 - L10/670B
- d13** Existing canopy removed and new polycarbonate canopy with metal frame supported on timber uprights with galvanized MS handrail between as NBS H32/120 - G20/260A - Q40/340A
- d15** New PV installation with proprietary non-penetrating fixings by roof manufacturer as NBS J41
- d16** New windows and doors as NBS L10 Windows & L20 Doors
- d17** Existing tarmac surface taken up and replaced with new concrete paviors to public realm as NBS Q25/315A
- d19** 3no, flagpoles as NBS Q50/190A

**PHASING NOTES**

Phasing is for indicative purposes. Contractors will be expected to developed detailed phasing proposals which address the issues of ensuring rigorous Health & Safety provisions are in place; and that disruption to normal operation of the school, particularly during examination periods, is minimised.

The indicated phasing is based on the principle of installing new plant equipment in the existing plant room before existing systems are decommissioned, and starting with an area which is available for decanting at short notice, then moving the specialist teaching areas first in order to minimise number of times that classes are required to relocate.

Certain phases and elements of the works will be required to be undertaken during the Summer holiday period, and it is anticipated that some of the phased areas indicated may be able to be combined.